



STATE OF NORTH CAROLINA
DEPARTMENT OF TRANSPORTATION

ROY COOPER
GOVERNOR

J.R. "JOEY" HOPKINS
SECRETARY

December 10, 2024

Addendum No. 1

RE: Contract # C204821

WBS # 35013.3.4

STATE FUNDED

Guilford County (U-4015A)

SR-1556 (GALLIMORE DAIRY RD) FROM NC-68 TO SOUTH OF AIRPARK
RD

December 17, 2024 Letting

To Whom It May Concern:

Reference is made to the plans furnished to you on this project.

The following revisions have been made to the Roadway plans.

Sheet Nos.	Revision
New 2B-1, 2B-2	Retaining Wall Detail Sheets added

Please staple new Sheets 2B-1 and 2B-2 after Sheet 2A-2 in your Plan set.

The contract will be prepared accordingly.

Sincerely,

Signed by:

 52C46046381F443...

Ronald E. Davenport, Jr., PE
State Contract Officer

RED/jjr
Attachments

cc: Mr. Wiley W. Jones III, PE
Mr. Wright R. Archer, III, PE
Mr. Ken Kennedy, PE
Mr. Malcolm Bell

Mr. Forrest Dungan, PE
Ms. Jaci Kincaid
Mr. Jon Weathersbee, PE
Project File (2)

RETAINING WALL #1 DETAIL

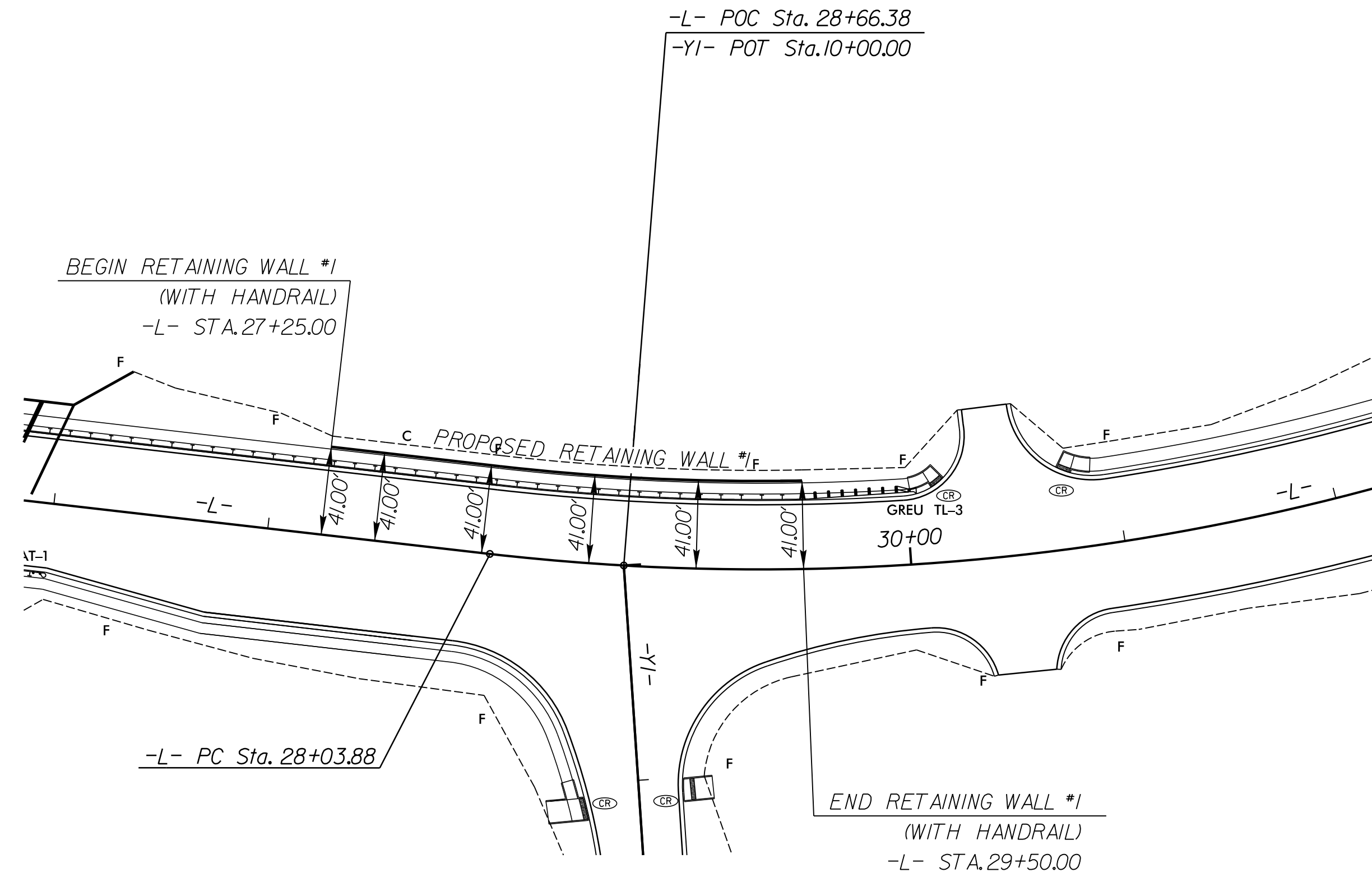
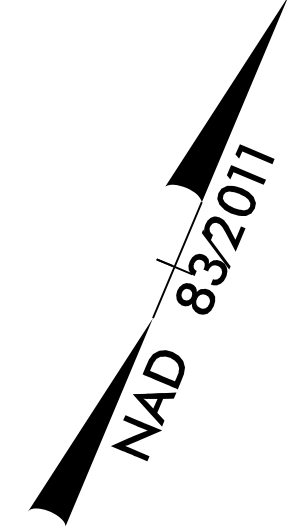

SEE SHEET 5
FOR PLAN VIEW
SEE SHEETS W-1 THRU W-5
FOR RETAINING WALL DETAILS

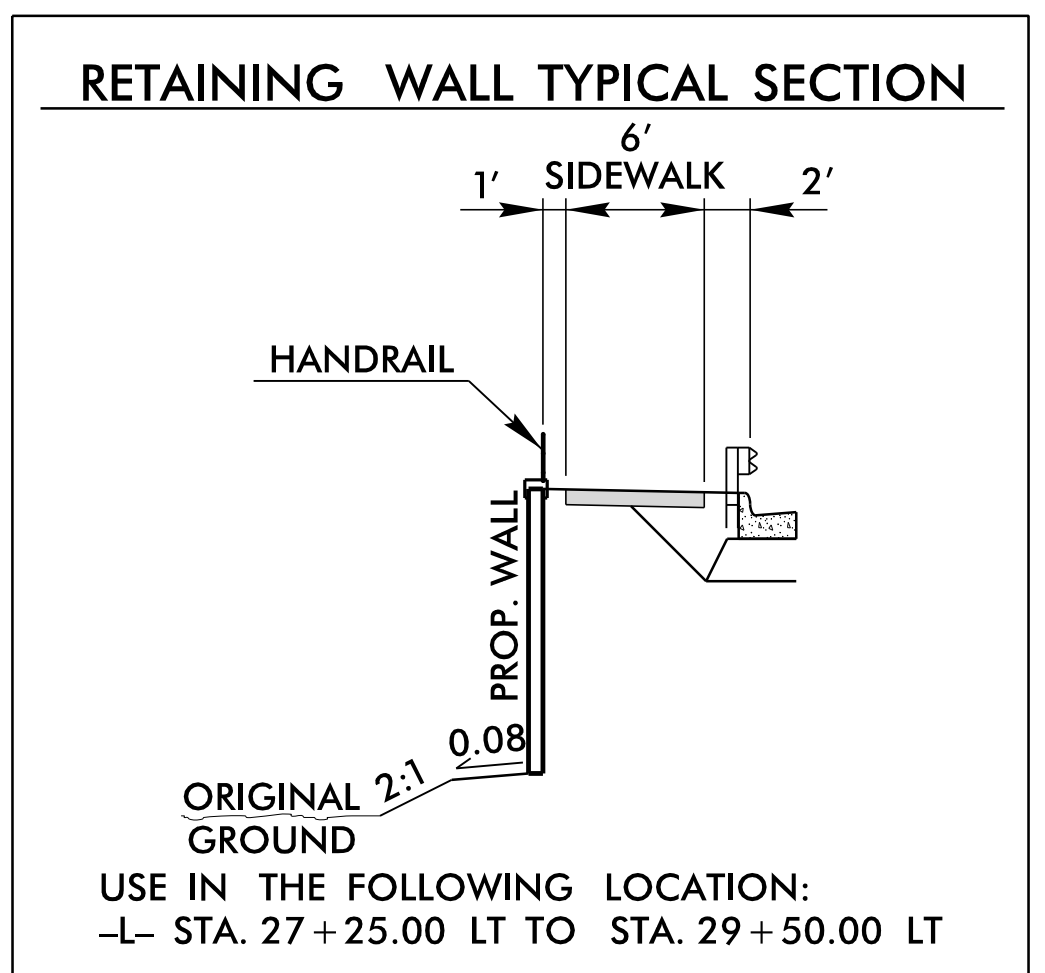

POINT NO.	-L- STATION	PROPOSED FINISHED GRADE (TOP)	PROPOSED FINISHED GRADE (BOT.)
1	27 + 25.00	811.07'	805.35'
2	27 + 50.00	811.84'	807.37'
3	28 + 00.00	813.41'	809.76'
4	28 + 50.00	815.04'	808.37'
5	29 + 00.00	816.98'	811.24'
6	29 + 50.00	818.92'	817.92'

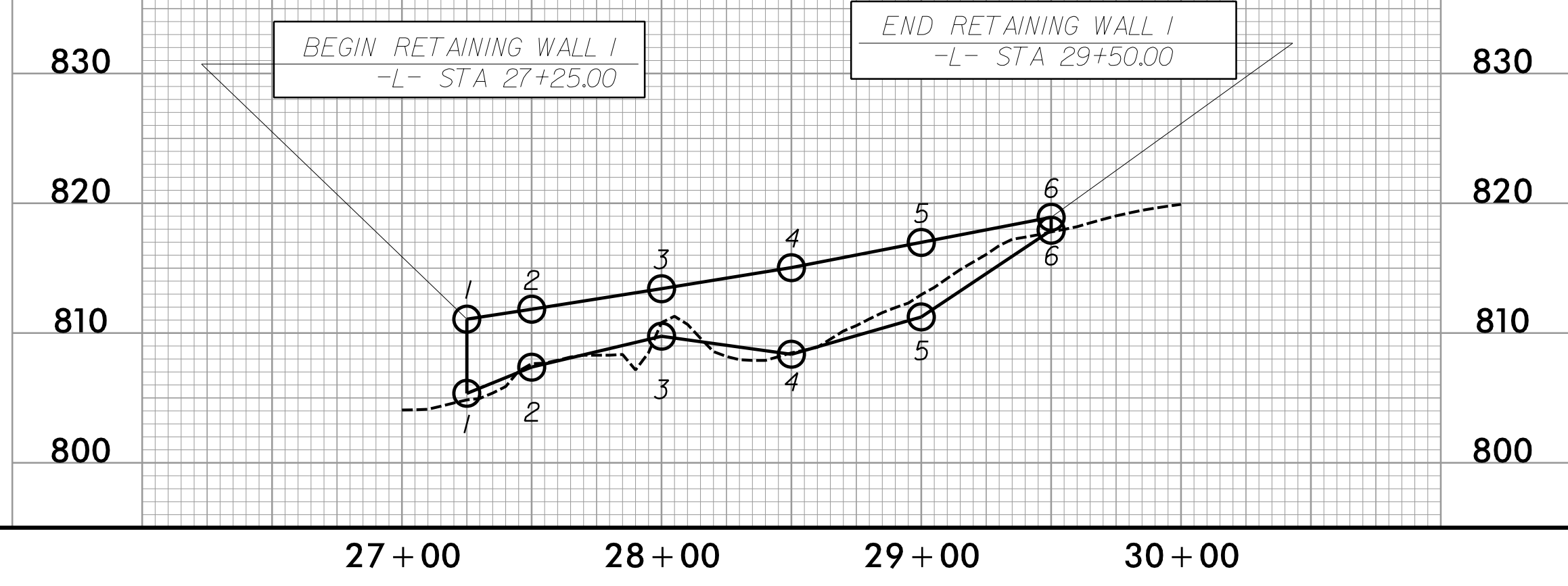

I:\Projects\2024\Projects\Plan Sheets\4015a_rdy_PSH_RET_WALL_02B-1.dgn

RETAINING WALL #2 DETAIL

RETAINING WALL #3 DETAIL

PROJECT REFERENCE NO. U-4015A	SHEET NO. 2B-2
RW SHEET NO.	
ROADWAY DESIGN ENGINEER	HYDRAULICS ENGINEER
DOCUMENT NOT CONSIDERED FINAL UNLESS ALL SIGNATURES COMPLETED	

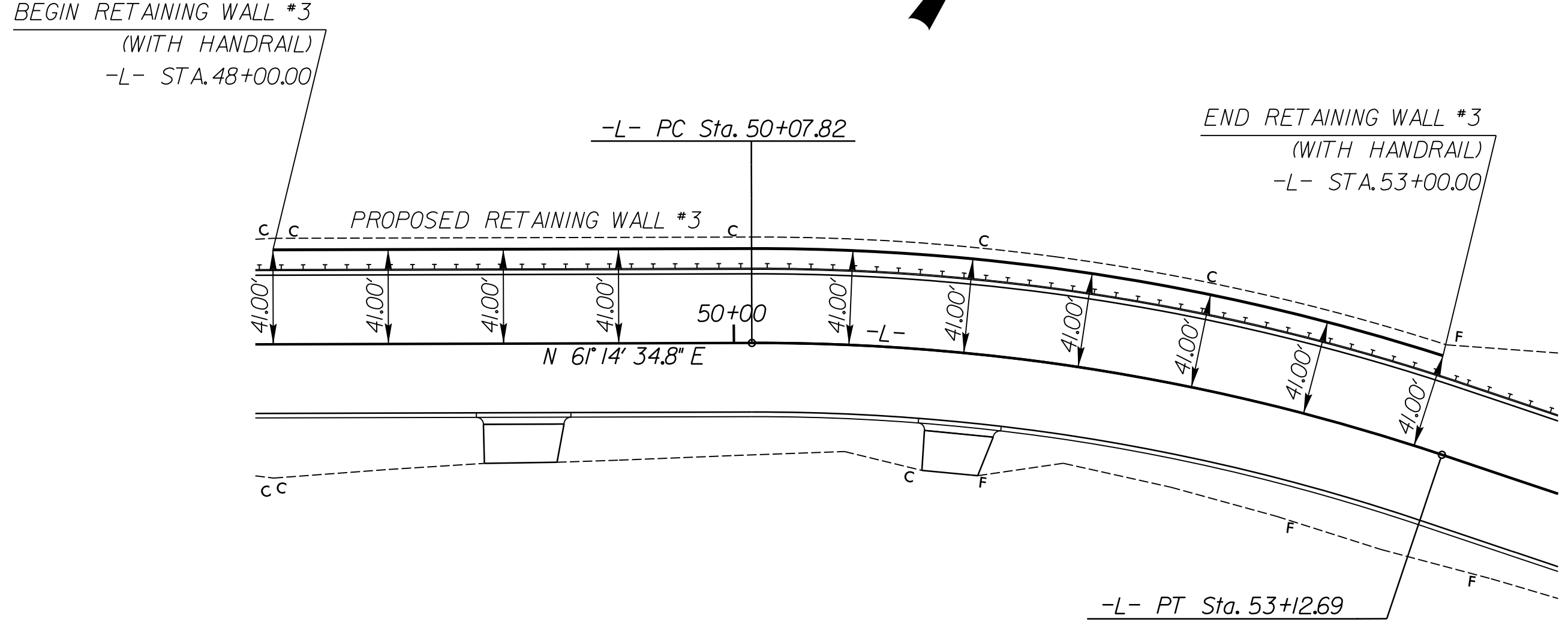
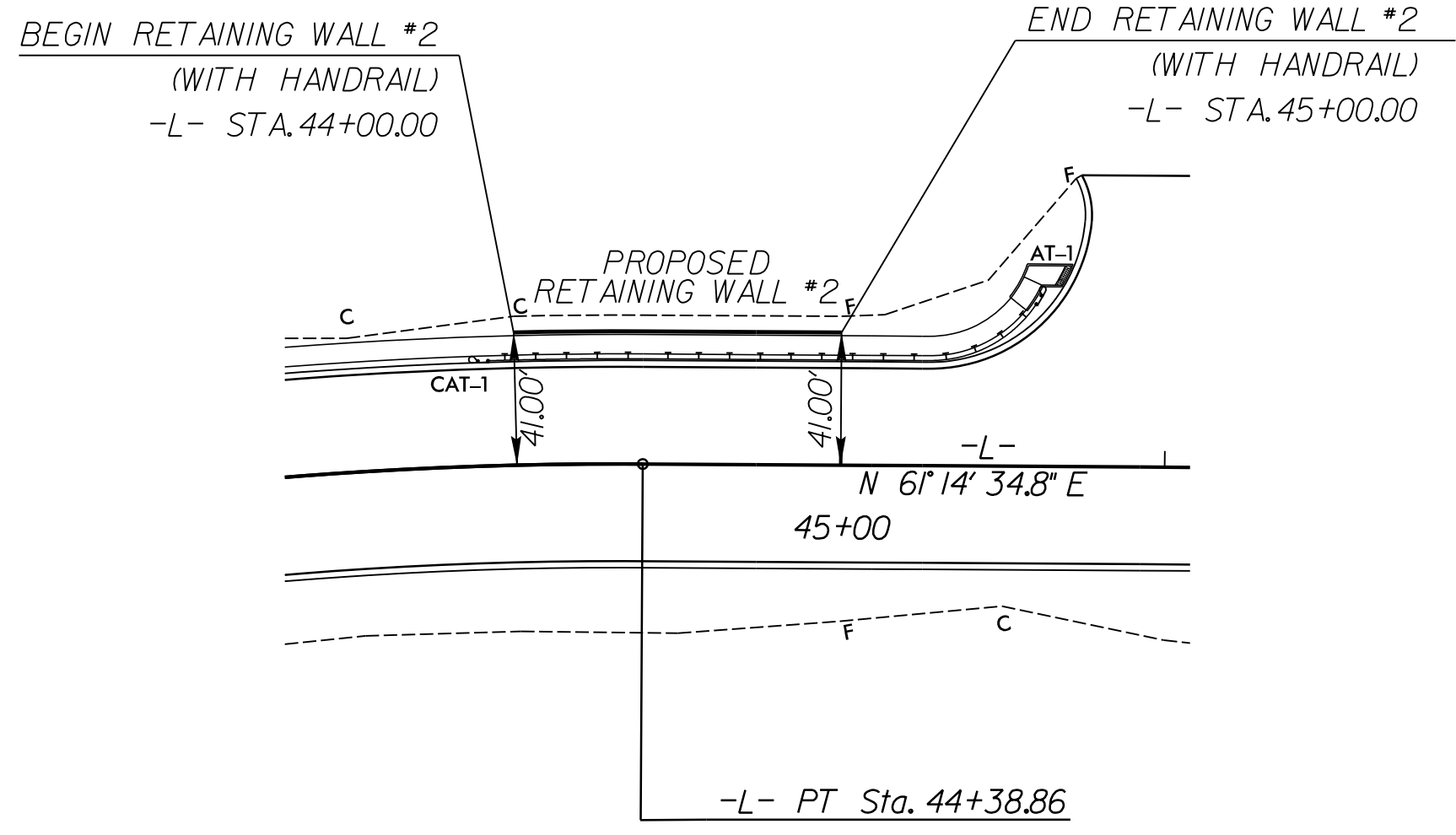

SEE SHEET 6
FOR PLAN VIEW
SEE SHEETS W-1 THRU W-5
FOR RETAINING WALL DETAILS

SEE SHEET 7
FOR PLAN VIEW
SEE SHEETS W-1 THRU W-5
FOR RETAINING WALL DETAILS

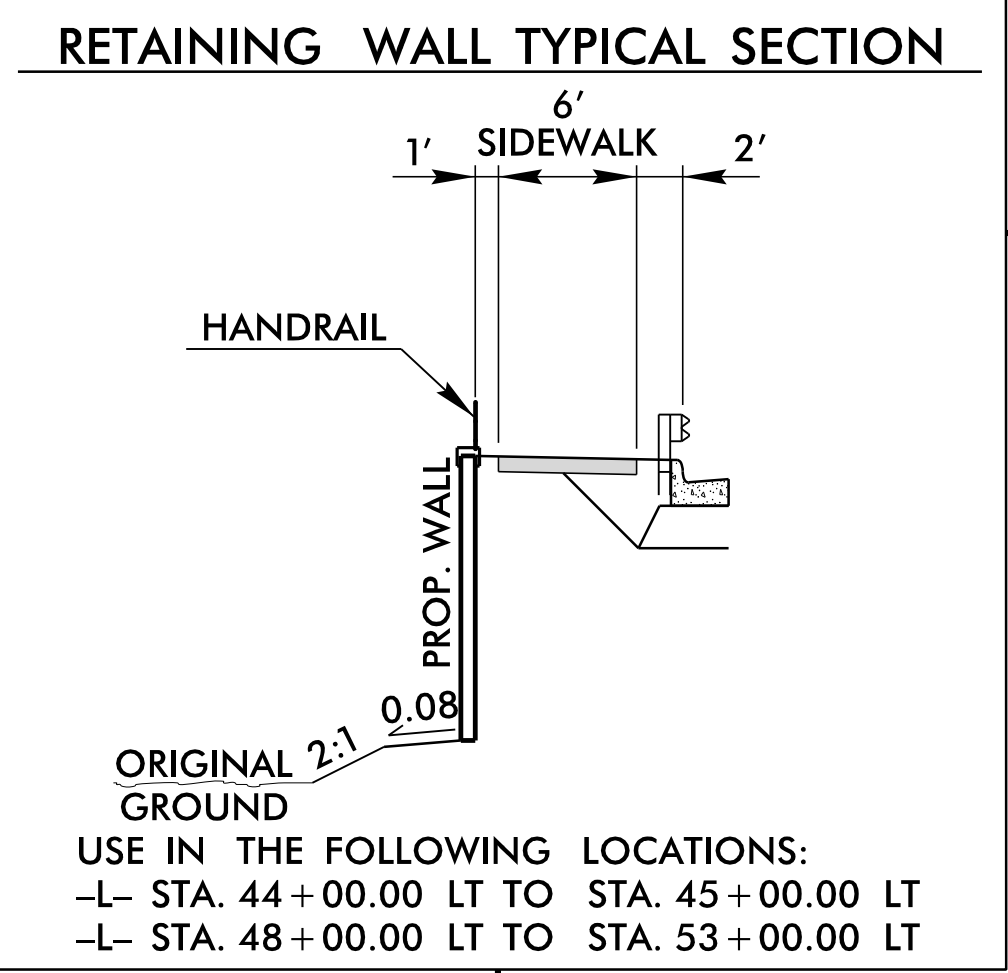

POINT NO.	-L- STATION	PROPOSED FINISHED GRADE (TOP)	PROPOSED FINISHED GRADE (BOT.)
1	44+00.00	850.83'	849.20'
2	44+02.43	850.94'	849.27'
3	44+50.00	853.20'	850.52'
4	44+94.71	855.52'	852.35'
5	45+00.00	855.80'	853.53'

POINT NO.	-L- STATION	PROPOSED FINISHED GRADE (TOP)	PROPOSED FINISHED GRADE (BOT.)
1	48+00.00	873.11'	870.76'
2	48+04.34	873.33'	870.88'
3	48+50.00	875.82'	872.42'
4	49+00.00	878.30'	872.79'
5	49+50.00	880.50'	873.04'
6	50+00.00	882.39'	872.48'
7	50+50.00	883.98'	871.98'
8	51+00.00	885.03'	874.33'
9	51+50.00	885.90'	877.88'
10	52+00.00	886.78'	883.05'
11	52+50.00	887.65'	885.41'
12	52+94.27	888.15'	885.41'
13	53+00.00	888.21'	885.19'

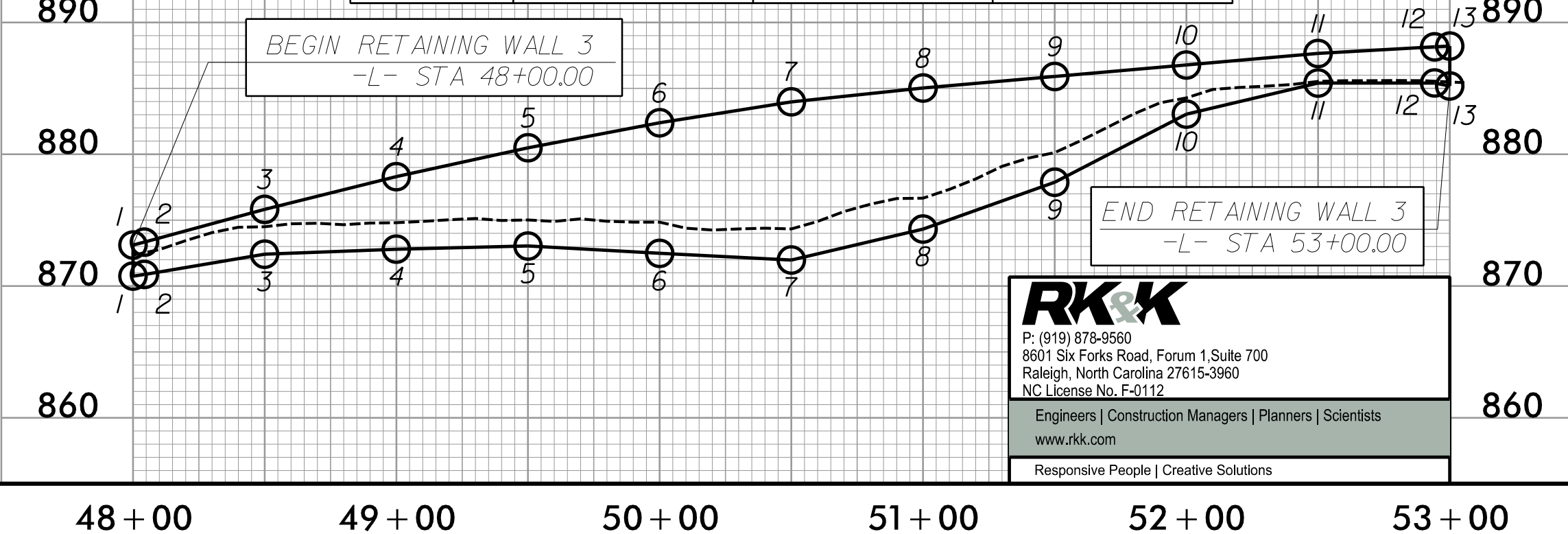
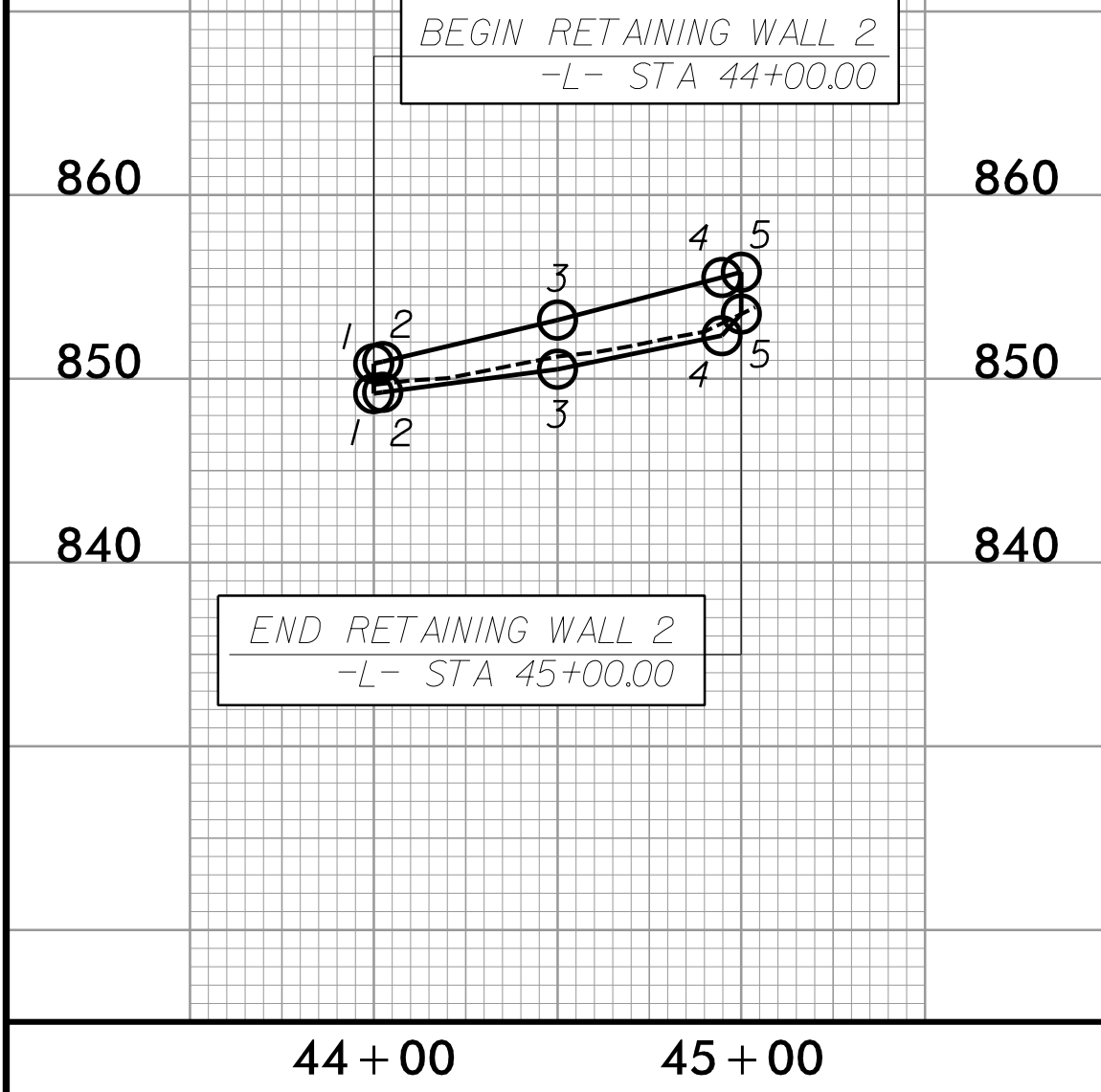

RK&K
P: (919) 878-9580
6801 Six Forks Road, Forum 1, Suite 700
Raleigh, North Carolina 27615-3960
NC License No. F-0112
www.rkk.com
Engineers | Construction Managers | Planners | Scientists
Responsive People | Creative Solutions

12/6/2024
C:\Roadway\Proj\Plan Sheets\4015a_rdy_PSH_RET_WALL_02B-2.dgn